

HYDRAULIC DIRECTIONAL CONTROL VALVE

DATASHEET
SERIES 9

HCV 91.11.11.1318-3.2



Hydraulic Directional Control Valve

- High quality
- Excellent performance
- Reliability
- Highly comprehensive qualification test programmes
- Applicable in all subsea production control systems worldwide
- Endures extreme high pressure

Basic Technical Specification

General	
Type	HCV 91.11.11.1318-3.2
Operation	Pulse activated Solenoid/Hydraulic operation to Closed/Open Position. Valve will latch to closed position when function pressure falls below a specified level
Port	3
Position	2
Pressure Transmitter	NA (optional)
Mounting	Subplate
Weigth	4.2 kg (9.2 lb)
Materials	
Body	AiSi 316
Slide	TuNi
Seat	TuNi
Pressures	
Proof Pressure Supply/Pilot/Return	1035 Bar / 570 Bar / 207 Bar (15.000 psi / 8.250 psi / 3.000 psi)
Supply Pressure	90 - 690 Bar (1.300 - 10.000 psi)
Pilot Pressure	90 - 345 Bar (1.300 - 5.000 psi)
Maximum Return Pressure	50 Bar, but never above supply pressure (725 psi)
External Pressure	350 Bar (5.000 psi)
Reset Supply Pressure	40 ± 10 bar (optional 70 ± 10 bar) (580 psi ± 145 psi)
Capacity	
Cv, P - A	0.20
Cv, A - R	0.18
Steady State Leakage	Less than 0.2 ml/min
Electric Data	
Nom. Voltage	24 V
Nom. Power	13 W
Operations	
No. of operations @ 690/ 345 bar (10.000/ 5.000 psi) supply pressure	50.000*
Operating Temperature	-10°C/ + 50°C (14°F / 122°F)
Fluid	
General	Water/glycol and mineral oil based subsea fluids

*The lubricity of different fluids varies, and will influence the No. of operations. Please contact Oceaneering Rotator

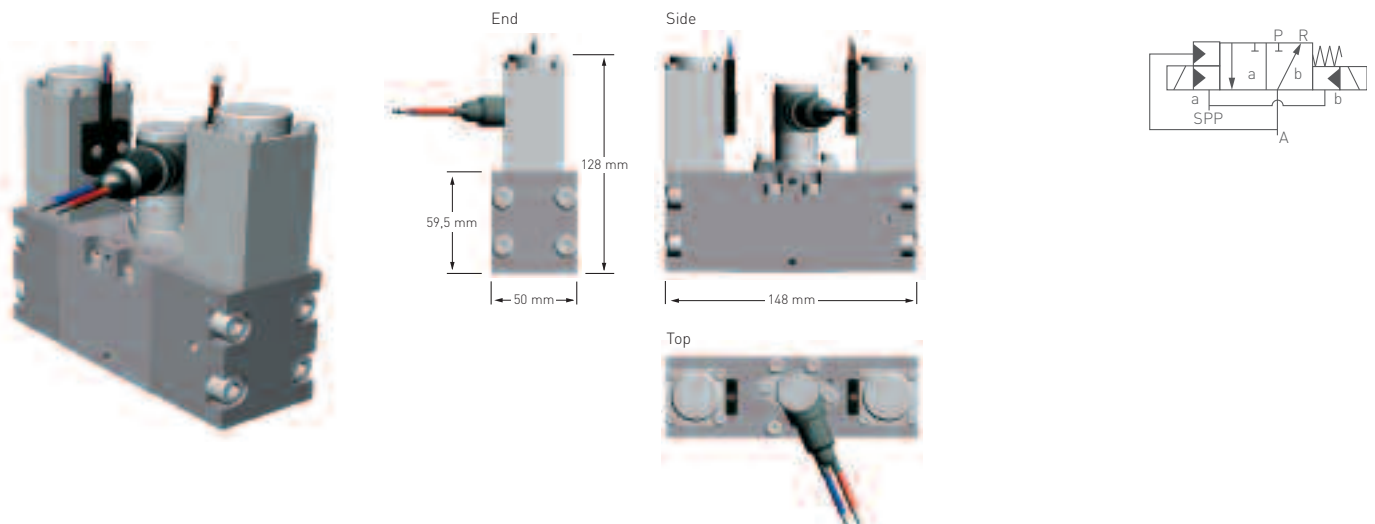

HYDRAULIC DIRECTIONAL CONTROL VALVE

DATASHEET
SERIES 9
HCV 91.11.51.00-3.2

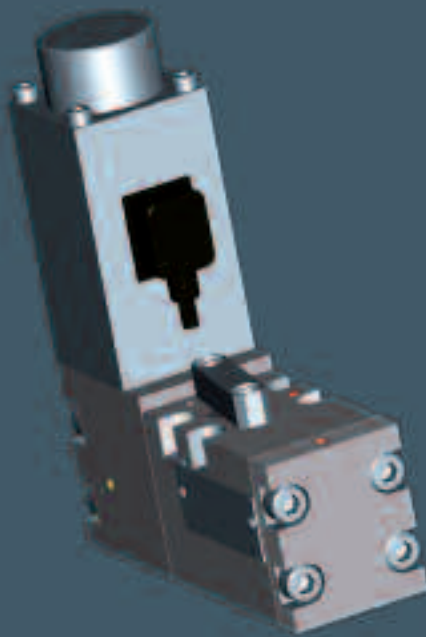

Hydraulic Directional Control Valve

- High quality
- Excellent performance
- Reliability
- Highly comprehensive qualification test programmes
- Applicable in all subsea production control systems worldwide
- Endures extreme high pressure

Basic Technical Specification

General	
Type	HCV 91.11.51.00-3.2
Operation	Continuously activated Solenoid/Hydraulic operation to Open Position. Pressure assisted spring return to closed position.
Port	3
Position	2
Pressure Transmitter	NA
Mounting	Subplate
Weigth	5.6 kg (12.3 lb)
Materials	
Body	AiSi 316
Slide	TuNi
Seat	TuNi
Pressures	
Proof Pressure Supply/Pilot/Return	1035 Bar / 570 Bar / 207 Bar (15.000 psi / 8.250 psi / 3.000 psi)
Supply Pressure	90 - 690 Bar (1.300 - 10.000 psi)
Pilot Pressure	90 - 345 Bar (1.300 - 5.000 psi)
Maximum Return Pressure	50 Bar, but never above supply pressure (725 psi)
External Pressure	350 Bar (5.000 psi)
Capacity	
Cv, P - A	0,20
Cv, A - R	0,18
Steady State Leakage	Less than 0.2 ml/min
Electric Data	
Nom. Voltage	24 V
Nom. Power	4 W
Operations	
No. of operations @ 345 bar (5.000 psi) supply pressure	50.000*
No. of operations @ 690 bar (10.000 psi) supply pressure	25.000*
Operating Temperature	-10°C/ + 50°C (14°F / 122°F)
Fluid	
General	Water/glycol and mineral oil based subsea fluids

*The lubricity of different fluids varies, and will influence the No. of operations. Please contact Oceaneering Rotator

